

## FLEXSERIES

PART NUM: SA-FC-SMUL

### LOADER & UNLOADER

#### Single Magazine Unloader/Loader

The single loader/unloader modules are used for the automatic loading and unloading of PCBs in SMD lines. It allows loading and unloading from the same side.

AOI laser marking labeling, screen printers, or test system can be interfaced to it.

#### Benefits of SA-FC-SMUL:

- Configurable with production flow from right or left
- Easy reconfiguration to different magazine types
- Finest and compact design
- Easy operation and maintenance
- Rack locking by upper and lower rack clamps
- Status tower lamp on top of machine
- Electric pusher for automatic PCBs insertion in line
- Suitable for all rack on the market

*Imagery for illustration purposes only. Please consult your local Seica Automation distributor for more information.*



#### Layout Module

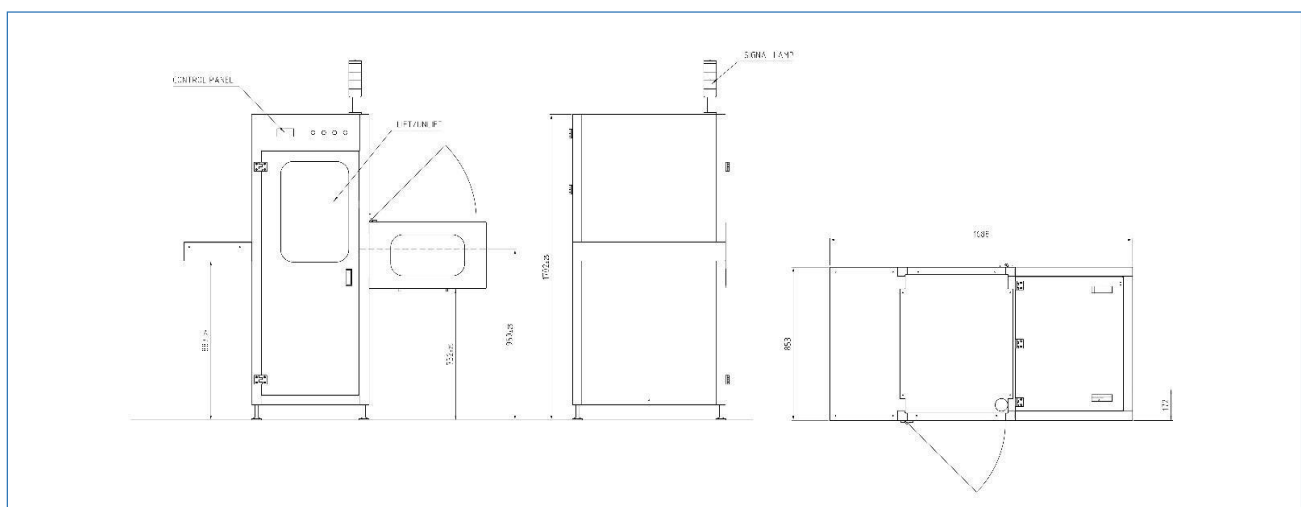

## FLEX SERIES GENERAL FEATURES

<b>TRANSPORT</b>	
<b>Height:</b>	950 mm +/- 25 mm
<b>Width:</b>	Min. 85 mm – Max 390 mm
<b>PCB edge space:</b>	Min. 3 mm
<b>Transfer direction:</b>	Left to right/Right to left
<b>Operating side:</b>	Front of the machine
<b>Fixed Rail:</b>	Front of the machine
<b>Interface:</b>	SMEMA standard extended SMEMA Optional Fuji, Panasonic, Sanyo, Siemens, SMPI, Special
<b>SMEMA cable length:</b>	3 m

<b>PANEL DIMENSION</b>	
<b>Length:</b>	Min. 80 mm – Max 510 mm
<b>Width:</b>	Min. 85 mm – Max 390 mm
<b>Optional width:</b>	Up to 460 mm on request
<b>Thickness:</b>	From 0.8 mm to 4.0 mm
<b>Component clearance:</b>	Top: 50 mm (80 mm on request) - Bottom: 20 mm (80 mm on request)
<b>PCB Max. weight:</b>	2 kg
<b>Max dimension of the rack:</b>	460x400x570 mm

### VARIOUS:

- CE safety compliant
- PLC microprocessor driven system
- Mechanical keyboard or LCD display with keyboard operation
- Automatic control of limit reached
- Single piece aluminium rails, proprietary design

### POWER SUPPLY:

230V 1Ph+N+G 50Hz

### CURRENT:

4 Ampere

### AIR SUPPLY:

0,6 Mpa

### WEIGHT:

150 Kg

### DIMENSION LxWxH:

1.588 x 853 x 1.702 mm

### COLOR:

RAL 7035

### FRAME:

Aluminium profiles

*All modules have ESD safe design and CE mark, each module has independent control system. Technical specification may change without any advice, please contact our representative office.*



[www.seica-automation.it](http://www.seica-automation.it)

[sales@seica-automation.com](mailto:sales@seica-automation.com)

[info@seica-automation.com](mailto:info@seica-automation.com)

+39 0362 1572 717

**Seica Automation s.r.l**

Via Sardegna, 4 20841

Carate Brianza (MB) ITALY

P.iva / C.F. 11044290010